

OLYMPUS CF



POWERCHAIR USER MANUAL

Congratulations on the purchase of your new Olympus Powerchair! The advanced ultra light-weight design and streamlined design ensures many years of enhanced trouble-free mobility. Correct use improves your mobility and quality of life.

Your safety is important to us.

Please read this owner's manual before using the powerchair. Improper use of the- could result in harm, injury or traffic accidents. Correct use improves your mobility and quality of life.

This owner's manual includes operation instructions for every aspect of the power-chair.

Contents

1.0	SAFETY GUIDELINES	3
2.0	PRE RIDE SAFETY CHECK	4
3.0	SPECIFICATION	5
4.0	COMPONENTS OF THE POWERCHAIR	6
5.0	OPERATION - JOYSTICK CONTROLLER	7
6.0	OPERATION - ASSEMBLY & DISASSEMBLY	9
7.0	OPERATION - FREEWHEEL LEVERS	13
8.0	OPERATION - GETTING ON YOUR POWERCHAIR	14
9.0	OPERATION - OPERATING YOUR SCOOTER	16
10.0	OPERATION - BATTERIES AND CHARGING	18
11.0	EMI	22
12.0	CARE & MAINTENANCE	23
13.0	OTHER INFORMATION	25
14.0	BASIC TROUBLESHOOTING	26
15.0	FLASH CODES	27
16.0	WARRANTY	28

1.0 SAFETY GUIDELINES



WARNING! An authorized Provider or qualified technician must perform the initial setup of this powerchair and must perform all of the procedures in this manual.

The symbols below are used throughout this owner's manual and on the powerchair to identify warnings and important information. It is very important for you to read them and understand them completely.



WARNING! Indicates a hazardous situation that could result in serious injury or death if it is not avoided.



CAUTION! Indicates a hazardous situation that could result in minor or slight injury if it is not avoided.



IMPORTANT! Indicates a hazardous situation that could result in damage to property if it is not avoided.



USEFUL TIP! Recommendations and information for efficient, trouble-free use.

Your powerchair is a state-of-the-art life-enhancement device designed to increase mobility. We provide an extensive variety of products to best fit the individual needs of the powerchair user. Please be aware that the final selection and purchasing decision regarding the type of powerchair to be used is the responsibility of the powerchair user who is capable of making such a decision and his/her health care professional (i.e., medical doctor, physical therapist, etc.).

The contents of this manual are based on the expectation that a mobility device expert has properly fitted the scooter to the user and has assisted the prescribing health care professional and/or the authorized provider in the instruction process for the use of the product.

There are certain situations, including some medical conditions, where the powerchair user will need to practice operating the scooter in the presence of a trained attendant. A trained attendant can be defined as a family member or care professional specially trained in assisting a powerchair user in various daily living activities.

As you begin using your powerchair during daily activities you will probably encounter situations in which you will need some practice. Simply take your time and you will soon be in full and confident control when using the powerchair.

Additional general information can be found on the supplemental information sheets and booklets included in your Owner's Package. Please fully read and review the information and keep it readily available for future reference.

2.0 PRE-RIDE SAFETY CHECKS

Get to know the feel of your powerchair and its capabilities. We recommend that you perform a safety check before each use to make sure your scooter operates smoothly and safely.

Perform the following inspections prior to using your Travel Powerchair

- Check the condition of the tyres. Make sure they are not damaged or excessively worn.
- Check all electrical connections. Make sure they are tight and not corroded.
- Check the battery condition meter to ensure the batteries are fully charged.
- Ensure the manual freewheel levers are in drive mode before sitting on the Powerchair.

If you discover a problem, contact your authorized Provider for assistance. Please refer to the Contact Information insert in your Owner's Package.



WARNING! This complete user manual should be read and fully understood before using and driving the powerchair.



WARNING! Never exceed the maximum permissible load – see 3.0 Specifications and never use the powerchair to transport more than one person.



WARNING! Never drive the powerchair under the influence of medication or alcohol.



WARNING! Never attempt to get onto or off your powerchair without first removing the key from the key switch. This will prevent the powerchair from moving if accidental throttle control lever contact is made.



WARNING! Never drive the powerchair with tiller lock in the locked position.



WARNING! This powerchair is not intended for use as a seat in a motor vehicle. The powerchair could fail in a vehicle impact, leading to serious injury or death of the occupant or injury to others.

3.0 SPECIFICATION

Model Reference	Olympus CF Powerchair
Speed (Max)	4mph (6km/h)
Travel Range (Max)*	10 mil. (16km)*
BatteryType - Standard	1 x 24V 10Ah Lithium
Battery Type - Endurance	1 x 24V 20Ah Lithium
User Weight (Max)	20st. (125 kg)
Transport Weight W/O Batteries	14 kg
Total Weight With Batteries	15.9 kg
Seat Width	440mm
Seat Depth	410mm
Seat Height	560mm
Overall Length	980mm
Overall Width	580mm
Overall Height	900mm
Climbing Gradient (Max)	6 Degrees
Folded Width	580mm
Folded Lenght	420mm
Folded Height	800mm
Arm Type	Fold-Back
Footrest Height	Adjustable
Tyre Type	Puncture Proof
Front Tyre	160mm
Rear Tyre	250mm
Backrest Type	Fixed
Footrest Type	Fold-Back
Charging Type	Off-Board and On-Board
Brake	Automatic Electromagnetic

REMARK: Komfi-Rider reserves the right to modify the specification if necessary. The final specification is subject to the individual scooter you purchase from your dealer.

*Subject to user weight and terrain

4.0 COMPONENTS OF THE POWERCHAIR



1	PUSH HANDLE	8	FREE WHEEL LEVER
2	JOYSTICK CONTROLLER	9	MOTOR
3	FOOTREST	10	FOLDING MECH
4	FRONT WHEEL	11	REMOVABLE SEAT CUSHION
5	BATTERY BOX	12	ARMREST FOLDING BUTTON
6	REAR WHEEL	13	ARMREST
7	ANTI TIP WHEEL	14	SEAT BACKREST

Your powerchair is equipped with a number of elements and parts. You should know these before using the powerchair. Designs and specifications may change without prior notice.

5.0 OPERATION - JOYSTICK CONTROLLER

The Joystick controller allows you to drive and steer your powerchair. Note it will be positioned on the righthand armrest but can be moved to the lefthand armrest if this is preferred.

C-1	ON/OFF BUTTON	C-5	HORN BUTTON
C-2	SPEED INDICATOR	C-6	INCREASE SPEED BUTTON
C-3	DECREASE SPEED BUTTON	C-7	JOYSTICK CONTROLLER
C-4	BATTERY GAUGE	C-8	BATTERY CHARGER SOCKET



5.1 ON/OFF BUTTON: (C-1)

This turns the power on and off your powerchair.

- Press once to turn on your powerchair.
- Press once to turn off your powerchair.

5.2 SPEED INDICATOR: (C-2)

This indicates the speed set by the Decrease Speed or Increase Speed buttons.

5.3 DECREASE SPEED BUTTON: (C-3)

Press this button to lower your 'top speed' of your powerchair.

5.4 BATTERY GAUGE: (C-4)

Indicates the voltage of the batteries:

- Green – batteries are fully charged.
- Yellow – batteries are half full.
- Red – batteries need charging.
- Beeping sound continuing – batteries are out of charge. Please recharge batteries.

5.5 HORN BUTTON: (C-5)

This button activates a warning horn. Your powerchair must be turned on for the horn to be operational. Do not hesitate to use the warning horn when doing so may prevent an accident or injury.

5.6 INCREASE SPEED BUTTON: (C-6)

Press this button to increase the 'top speed' of your powerchair to 4mph.

5.7 JOYSTICK CONTROLLER: (C-7)

This Joystick allows you to control the forward speed and the reverse speed of your powerchair up to the maximum speed you pre-set with the speed decrease/increase buttons. The Joystick also allows you to turn the powerchair.

To move forward: Push the joystick forward.

To move backward: Pull the joystick backward.

To steer to the left: Move the joystick to the left.

To steer to the right: Move the joystick to the right.



WARNING! Never attempt to get onto or off your powerchair without first turning off the Joystick controller. This will prevent the powerchair from moving if accidental Joystick control contact is made.



We recommend that you start driving your powerchair at the slower speed (use Decrease button).

5.8 BATTERY CHARGER SOCKET: (C-8)

The Charger Socket is positioned on the controller for charging your battery and also the battery box. See '10.0 Batteries and Charging' for further information.



WARNING! Chargers are selected precisely for particular applications and are especially matched to the type, size, and chemical formulation of specific batteries. For the safest and most efficient charging of your scooter's batteries, we recommend use of the charger supplied as original equipment with your product only. Any charging method resulting in batteries being charged individually is especially prohibited.



WARNING! Do not attempt to disassemble the battery from the battery pack or refit the battery.



WARNING! If your battery charger has not been tested and approved for outdoor use, then do not expose it to adverse or extreme weather conditions. If the battery charger is exposed to adverse or extreme weather conditions, then it must be allowed to adjust to the difference in environmental conditions before use indoors. Refer to the manual supplied with the battery charger for more information.

6.0 OPERATION - ASSEMBLY & DISASSEMBLY

6.1 UNFOLDING WHEELCHAIR

- Stand to the side of the wheelchair holding the backrest and front of seat (Fig 6.1.1).
- Push apart the backrest and seat (Fig 6.1.2) to the fully unfolded position. You will here an audible click sound as the folding lock is engaged.
- Stand behind the wheelchair and gently push forward the backrest to make sure the folding lock is fully engaged.
- Push down the foot plate. Your wheelchair is now ready for use.

Fig 6.1.1



Fig 6.1.2



6.2 FOLDING WHEELCHAIR

- To fold the wheelchair, stand directly behind and hold onto the rear handles.
 - Place your foot onto the fold release lever and push down with your foot (Fig 6.2.1) at the same time gently push the back of the chair forwards with your hands to disengage the folding lock. Remove your foot from the lever as soon as the wheelchair begins to fold !
- Note: You must remove your foot from the fold release lever as soon as the wheelchair begins to fold to prevent trapping your foot in the fold mechanism!**
- With the folding lock now disengaged, stand to the side of the wheelchair and pull the rear of chair and seat together (Fig 6.2.2.) until fully folded (Fig 6.2.3).
- With the wheelchair folded, you can now stand the chair on its rear stands as shown (Fig 6.2.4).
- You can now fold the footrest back into the chair.

Fig 6.2.1



Fig 6.2.2



Fig 6.2.3



Fig 6.2.4



WARNING! You must remove your foot from the fold release lever as soon as the wheelchair begins to fold to prevent trapping your foot in the fold mechanism!

6.3 FOLDING ARMRESTS

The armrests can be quickly folded back out of the way for when transferring to and from the wheelchair as shown.

- Press the red release button (Fig 6.3.1) and lift armrest (Fig 6.3.2).

FIG 6.3.1



FIG 6.3.2



6.4 INSERTING THE BATTERY BOX

The battery box is fast and easy to insert or remove for charging and transport.

- To insert the box, simply place into position as shown (Fig 6.4.1) and push the box forwards making sure the battery box lines up correctly with the frame guide rails.
- Continue to push the battery box forwards until the release clip clicks into position (Fig 6.4.2).
- To remove the box, pull back the release clip (Fig 6.4.3) and pull out the box.

Note: See 10.0 Batteries and Charging for how to charge your batteries.

FIG 6.4.1



FIG 6.4.2

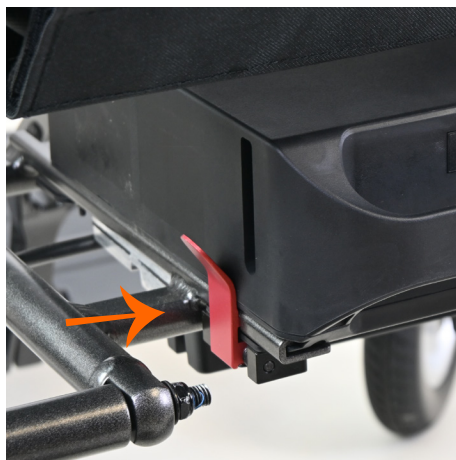

FIG 6.4.3



6.5 LIFTING AND HANDLING

With the footrest folded back, the wheelchair can be lifted as shown in Fig 6.5.1.

- If possible lift the scooter with help of another person, if not possible, you can lift the chair as shown in Fig 6.5.1 with one hand on top of the wheelchair frame and one hand lower down on the frame.



FIG 6.5.1



CAUTION! Lifting weight beyond your physical capability may result in personal injury. Ask for assistance when necessary while lifting.

6.6 SEATING - REMOVABLE SEAT CUSHION

- The seat cushion is positioned with Velcro can be removed quickly for cleaning etc.



6.7 ANTI TIP WHEELS

The anti-tip wheels are positioned at the rear of the powerchair as shown (Fig6.71).

The powerchair should never be used without the anti-tip wheels being correctly fitted.



FIG 6.71



WARNINIG! The anti-tip wheels are only effective on firm ground. They will sink into soft ground such as grass, snow, or mud if the scooter rests on them. They will lose their effect and the powerchair could tip over.



WARNINIG! Never sit or drive the wheelchair if the anti-tip wheels are missing or not correctly fitted.

6.7 CHANGING POSTION OF JOYSTICK CONTROLLER

The Joystick controller can be moved from the standard right hand arm position to the left hand by un-doing the handwheel and sliding out the controller (Fig 6.7.1). The controller can then be re-positioned on to the left arm rest.



Fig 6.7.1

6.8 ATTENDANT JOYSTICK CONTROLLER BRACKET

The Joystick controller can also be moved the rear push handle allowing the attendant to control your powerchair.

- Un-do the bracket and install onto the rear push handle.

7.0 FREEWHEEL LEVERS

The Freewheel levers on the powerchair are located at the rear as shown below. The free-wheel levers dis-engage the motors which allows the powerchair to be manually pushed if required.

- To engage the motors to 'Drive' position, push the levers downwards (Fig 7.0.2). This will allow you to drive the powerchair via the Joystick controller.
- To dis-engage the motors to 'Freewheel' position, pull the levers upwards (Fig 7.0.3). This will allow you to manually push the chair.

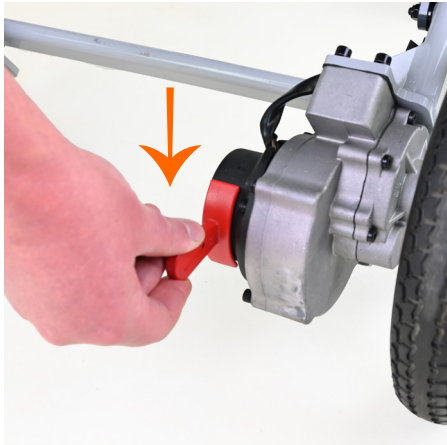

Fig 7.0.1 Drive Mode (Push down)



Fig 7.0.2 Freewheel Mode (Lift Up)



WARNING! Before placing your powerchair into or taking it out of freewheel mode, turn off the Joystick controller. Never sit on the powerchair when it is in freewheel mode. Never put your scooter in freewheel mode on any incline.



WARNING! Disengage the drive motors only on a level surface.



WARNING! When your powerchair is in freewheel mode, the braking system is disengaged.



WARNING! Stand to the rear of the powerchair to engage or disengage freewheel mode. Never sit on a powerchair to do this.



WARNING! After you have finished pushing your powerchair, always return it to the drive mode to lock the brakes.



WARNING! Never sit on the powerchair when it is in freewheel mode.

8.0 GETTING IN ON/OFF YOUR POWERCHAIR

You will have to learn the characteristics of your wheelchair. It is most important to learn the safest methods to develop the daily activities in accordance with your lifestyle. Consult your medical advisor or therapist for assistance by developing safe and effective techniques for your daily activities and your physical possibilities.

Daily operations such as getting off the wheelchair, reaching and bending in the wheelchair will cause a change of weight distribution and a change in the center of gravity of you and your wheelchair.

8.1 TRANSFERRING – GETTING ON YOUR POWERCHAIR

Transferring in or out of a wheelchair is a difficult maneuver. Consult your physical therapist for assistance in developing your individual technique. The possibilities you have for making a transfer are depending on your physical characteristics. We advise you to discuss this first with your physical therapist. However, if you have sufficient body strength and you want to transfer to and from the wheelchair you will best do this in the following manner:

- First of all you must make sure that your wheelchair stands as closely as possible to the place of where you wish to transfer from.
- Make certain that the Joystick controller is turned off. This will prevent the powerchair from moving if accidental Joystick control contact is made.
- Only transfer on and off your powerchair on a firm and level surface.

8.2 TRANSFERRING – GETTING OFF YOUR POWERCHAIR

To get into your wheelchair you need to do the same things as when you want to get out of the wheelchair, only in the reversed order.



WARNING! The following can adversely affect steering and stability while operating your powerchair:

- Holding onto or attaching a leash to walk your pet.
- Carrying passengers (including pets).
- Hanging any article from the arms.
- Towing or being pushed by another motorized vehicle.



WARNING! Never stand on the footrest, this will cause the wheelchair to tip over and injure the user (Fig 5.0.1).



Fig 5.0.1



WARNING! Always place the wheelchair on a stable, flat surface and switch off the controller before transferring to or from the wheelchair.



WARNING! Unauthorized modification and or use of parts not supplied by Komfi Rider will invalidate the warranty of this wheelchair and may lead to injury to the user and or damage to the wheelchair.



WARNING! Never attempt to get onto or off your powerchair without first turning off the Joystick controller. This will prevent the powerchair from moving if accidental Joystick control contact is made.



WARNING! Never descend or climb a gradient which is greater than the recommended maximum see 4.0 Specifications°.



WARNING! Never drive across (traverse) an incline, ramp etc, in any direction.



WARNING! Surface temperatures can increase when exposed to external sources of heat (e.g. sunlight).



CAUTION! When transferring onto and off your powerchair always make sure you are on a firm and level surface.



WARNING! Never leave the manual freewheel lever in the freewheel position unless you are manually pushing your wheelchair.

9.0 OPERATING YOUR POWERCHAIR

9.1 Starting:

- Make sure you are seated safely and properly on your powerchair.
- Press the 'On' button on your Joystick controller.
- By pressing the Decrease speed button on your Joystick controller, set the slowest setting.
- Place your hand on the Joystick controller:

To move forward: Push the joystick forward.

To move backward: Pull the joystick backward.

To steer to the left: Move the joystick to the left.

To steer to the right: Move the joystick to the right.



WARNING! Turning your powerchair too sharply at high speed will cause loss of control and balance and will result in the scooter tipping over resulting in serious injury or death.



WARNING! Never attempt to get onto or off your powerchair without first turning off the Joystick controller. This will prevent the powerchair from moving if accidental Joystick control contact is made.



CAUTION! Reaching: We strongly recommend that you seek the help of an attendant to pick something up for you.

9.3 Driving on inclines, hills, slopes and ramps:

- When driving your powerchair, never descend or climb a gradient which is greater than recommended – see 3.0 Specifications. Failure to do so could result in serious injury or death.
- When driving up a ramp, curb or incline – lean forward to move the centre of gravity of the scooter forward for maximum stability and safety.
- Drive with extreme caution when attempting to drive up or down any incline, access ramp etc, always drive at a slow speed.
- Always drive straight up or straight down an incline, ramp, slope etc.
- Never drive across (traverse) an incline, ramp etc, in any direction – Driving across an incline, ramp etc could result in turning the powerchair over resulting in serious injury or death.
- Try to keep your powerchair moving when climbing or descending an incline. If you have to stop, restart and accelerate slowly and carefully.



WARNING! Never descend or climb a gradient which is greater than the recommended maximum see 3.0 Specifications°.



WARNING! Never drive across (traverse) an incline, ramp etc, in any direction.

9.4 Weight Climbing limits:

- The weight capacity limits are shown in the below.

52kg	80kg	115kg
6 degree	4 degree	2 degree

- The climbing degree will be affected by weight capacity, driving speed, and ramp degree, and powerchair parameter.
- To prevent any danger of damaging the motor, please avoid driving up long ramps & hills or any 'off-road' uneven terrain.



WARNING! While you are driving down a slope, if your powerchair starts to move faster than you feel safe, release the throttle control lever slowly. It will allow your scooter to decelerate and slow down.



WARNING! Stopping distances can be significantly increased when driving on slopes compared to driving on level ground.

10.0 BATTERIES AND CHARGING

10.1 General Information & Instructions on Charging:

Your powerchair requires a lithium battery that is sealed and maintenance free. The battery is recharged by the supplied off-board charging system.

10.2 Charging your battery:

- Before charging your battery make sure you have fully read and understand the instructions and safety/warning notes on charging and battery care in this manual and also the charger's manual.
- Turn off the powerchairs power,
- Position your powerchair/ battery box near to a mains electrical socket.
- Decide on which charging socket to use - You have a choice of two charging sockets:
 1. Battery Box Socket (Fig 10.2.1) (allows you to charge batteries 'off board' e.g. in your house).
 2. Tiller Charging Socket (Fig 10.2.2) (saves you having to bend down to plug in charger).
- Slide away the cover of the charger outlet point either positioned on the front of the battery box (Fig 10.2.1) or the Tiller Charging Socket (Fig 10.2.2).

Fig 10.2.1.



Fig 10.2.2.



- Put the charger plug into the outlet point.
- Do not switch on the battery charger until all the plugs are in position.
- Switch on the on/off button (Fig 10.2.1) to 'on' position.
- The LED light on the battery charger will show amber while charging.
- The LED light on the battery charger will show green when batteries are fully charged.
- Turn off the mains power to the charger before removing the charger plug from charging outlet.
- Note: The LED light will show red when the charger is switched on at the mains but not charging.

11.3 Battery Charging & Care

To extend your battery's useful life as long as possible, you need to care for it properly. That means adopting good charging habits and taking care with battery storage. Following the points set out below will help to significantly lengthen your battery's useful life.



- **Do not overcharge:**

- Lithium-ion batteries cannot tolerate overcharging and because of this should not be trickle charged continuously.
- The closer the battery gets to 100 % charge the slower it charges: the charger is actively reducing the current to go easy on the battery cells. However, since these final few percent put a lot of stress on the cells, batteries also tend to get much warmer at the end of the charge cycle.
- Overcharging can result in the deposition of lithium metal on one of the electrodes, which then becomes a fire hazard.
- If the charge level is at 80 % or more you should avoid recharging the battery before using it.



- **Do not fully discharge:**

- Avoid regularly fully discharging your battery and it is best not to let your battery go under 20%.
- If the battery is empty, you should avoid charging it to only 20 % and then using it.
- An empty battery should be charged to 30 % or even better 70 % as quickly as possible.



- **Avoid full charge/discharge cycles:**

- Full charge/discharge cycles should be avoided if possible.



- **Correct charging methods:**

- Only use the charger supplied with the scooter, or a charger that has been approved by Komfi-Rider.
- Do not charge your battery under extreme temperatures. High temperatures above 30°C are not recommended for charging as well as low temperatures below 10°C.
- Protect your charger from sources of heat such as heaters and direct sunlight. If the battery charger overheats, charging current will be reduced and the charging process delayed.
- The battery must be charged using a charger that follows a rigid charging regime and has both overheat protection and time-out protection.
- When charging your battery do not leave them on charge unattended / in an unoccupied area.
- Regularly observe the lithium battery during charging and for 15 minutes afterwards to check. Turn off your charger immediately if your battery gives off an odour, generates heat or appears abnormal in any way.



- **Correct battery storage:**

- Do not store your battery fully charged for extended periods of more than 24 hours. Discharge to about 50-60% capacity for storage for long periods.

- Do not store your battery at low charge, charge it before storing, you should charge it to 50-60% and keep it between 30 and 70 % at all times.
- Lithium-ion batteries don't like extreme temperatures. Whenever possible store in temperatures between 10 to 30°C and avoid leaving your battery in a hot vehicle that's in direct sunlight or in chilly rooms.
- Do not store your battery in damp or dirty/dusty locations.
- Do not crush, break open or physically abuse the batteries or the equipment that contains them.



WARNING! Risk of explosion and destruction of batteries if the wrong battery charger is used. Only ever use the battery charger supplied with your vehicle, or a charger that has been approved by Komfi-Rider.



WARNING! Do not use or store the battery near sources of heat such as a fire or heater.



WARNING! Never attempt to open or disassemble the charger. If the battery charger does not appear to be working correctly, contact your authorized provider.



WARNING! When charging batteries do not leave them on charge unattended / in an unoccupied area in case, through a latent defect, they burst into flame during the process. There needs to be someone present who knows how to deal with an emergency.



WARNING! Do not use the battery if it gives off an odour, generates heat or appears abnormal in any way. If the battery is in use or being recharged, remove it from the device or charger immediately and discontinue use. Contact your authorized provider.



WARNING! Risk of electric shock and damage to the battery charger if it gets wet. Always protect the battery charger from water and always charge in a dry environment and with dry hands.



WARNING! Risk of short circuit and electric shock if the battery charger has been damaged. Never use the charger if it has been dropped or damaged.



WARNING! Risk of electric shock and damage to the batteries – Never attempt to recharge the batteries by attaching cables directly to the battery terminals.



WARNING! Risk of fire and electric shock if a damaged extension cable is used. Only ever use an extension cable if it is absolutely necessary. If you have to use an extension cable make sure it is in good condition.



WARNING! Risk of injury if using the powerchair during charging. Do not attempt to recharge the batteries and operate the powerchair at the same time. Do not sit in the scooter while charging the batteries.



WARNING! Chargers are selected precisely for particular applications and are especially matched to the type, size, and chemical formulation of specific batteries. For the safest and most efficient charging of your powerchair's batteries, we recommend use of the charger supplied as original equipment with your product only. Any charging method resulting in batteries being charged individually is especially prohibited.



WARNING! Never attempt to disassemble the battery from the battery box or refit the battery. Contact your authorized provider.



WARNING! If your battery charger has not been tested and approved for outdoor use, then do not expose it to adverse or extreme weather conditions. If the battery charger is exposed to adverse or extreme weather conditions, then it must be allowed to adjust to the difference in environmental conditions before use indoors. Refer to the manual supplied with the battery charger for more information.



WARNING! Never use or store the battery where it is exposed to high temperatures. Leaving the battery in a car on a hot day or in an area of direct sunlight such as a window will reduce battery performance and shorten service life.



WARNING! Risk of explosion and electric shock if batteries are charged when incorrectly wired. Never attempt to open or disassemble the battery box. If the batteries do not appear to be working correctly, contact your authorized provider.

11.0 EMI / RFI

The rapid development of electronics, especially in the area of communications, has saturated our environment with electromagnetic (radio) waves that are emitted by television transmitters, cellular phones, citizen's band radios (CB's), amateur radios (ham radios), wireless computer left, microwave transmitters, paging transmitters etc. These electromagnetic (EM) waves are invisible and increase in strength the closer one gets to the source of transmission. When these energy waves act upon electrical devices and cause them to malfunction or to function in an erratic or uncontrolled manner, they are referred to as Electromagnetic Interference (EMI) or Radio Frequency Interference (RFI).

EMI / RFI and your Powerchair

All electrically powered vehicles, including powerchairs are susceptible to Electromagnetic Interference / Radio Frequency Interference (EMI / RFI). This interference could result in abnormal, unintended movement of your scooter.



WARNING! Unintended movement or brake release can cause an accident or injury

The FDA has determined that each make and model of powerchair can resist EMI / RFI to a certain level. The higher the level of resistance, the greater the degree of protection from EMI / RFI – measured in volts per meter (V/m). The FDA has also determined that current technology is capable of providing 20 V/m of resistance to interference. This product has been tested and has passed an immunity level of 20 V/m.

EMI / RFI recommendations

- Do not turn on or use hand-held personal electronic communication devices such as cellular phones, walkie-talkies and CB radios while your scooter is turned on;
- Be aware of any nearby transmitters (radio, television, microwave, etc.) on your intended route and avoid operating your powerchair close to any of those transmitters;
- Turn off the power if your scooter is going to be in a stationary position for any length of time;
- Be aware that adding accessories or components or modifying your powerchair may make it more susceptible to EMI / RFI;



WARNING! Turn off your powerchair as soon as it is safely possible if unintended or uncontrollable motion occurs or if unintended park brake release occurs.

12.0 CARE AND MAINTENANCE

12.1 DAILY CHECK Please always check your powerchair daily, for the follownig:

ITEM TO CHECK	INSPECTION	IF THE INSPECTION FAILS
Freewheel Levers	Check for correct function..	Contact your dealer.
Horn	Check for correct function.	Contact your dealer.
Joystick Control-ler	Check that it functions correctly.	Contact your dealer.
Electromechani-cal Brake	Push the Joystick controller to drive a little then release Joystick to check the brake works correctly.	Contact your dealer.
Battery Gauge	Check the battery gauge that it is display- ing and if its showing low power.	Contact your dealer if bat- tery gauge s not working. Recharge the battery imme- diately if low.
Anti Tip Wheels	Are the ant tip wheels fitted correctly.	Contact your dealer.

12.2 WEEKLY CHECK Please always check your scooter weekly for the follownig:

ITEM TO CHECK	INSPECTION	IF THE INSPECTION FAILS
Speed Dial	Check for correct function..	Contact your dealer.
Seating	Check that armrest screws are tightened correctly. Check that the seat folding frame is is correctly fitted and tightened.	Contact your dealer.
Wheels/Tyres	If your powerchair has pneumatic tyres, in- flate to the correct pressure. Drive wheels turn without wobbling. Tire thread depth is not less than 0.5mm. There are no foreign objects in the tires. That the wheel bolts are correctly tight- ened.	Contact your dealer.
Motor	Does the motor sound normal?	Contact your dealer.
Battrey Box	Check for signs of damage to the case.	Contact your dealer.
Battery Charger	Check that the charger is functioning cor- rectly and the batteries are charging cor- rectly.	Contact your dealer.

12.3 MONTHLY CHECK Please always check your scooter monthly for the follownig:

ITEM TO CHECK	INSPECTION	IF THE INSPECTION FAILS
Upholstery	Check for worn fabric.	Contact your dealer.
Tiller Handle	Check it is tight and not loose.	Contact your dealer.

12.4 REGULAR SERVICING

To make sure your powerchair continues to perform to its best and is maintained in good working order you will need to regularly have your scooter checked and serviced by your powerchair dealer.

12.5 TYRES

The condition of the tyres depends on how you drive and use your powerchair.

Inspecting Tyre Treads. Please check the tread depth regularly. Replace the tyres when the tread depth is less than 0.5 mm. If you have pneumatic tyres then check the pressure regularly. See 3.0 Specifications for the correct psi.

12.6 UNIQUE IDENTIFICATION NUMBER

Your powerchair has a unique identification number which is located on your powerchair at several different locations, on the rear and front chassis and under the seat. This unique number will enable your authorized supplier to confirm with Komfi-Rider if necessary, the age of your powerchair and when it was purchased.

12.7 CLEANING

- Do not use water, oil or other chemical solutions to clean your powerchair. Be sure NOT to spray the powerchair with the water as this can damage the electronic components.
- Use a dry or moist cloth and mild, non-abrasive cleanser to clean the plastic and metal parts of your powerchair. Avoid using products that may scratch the surface of your Travel powerchair. If necessary, clean your product with an approved disinfectant. Make sure the disinfectant is safe for use on your product before application.
- Please take the scooter to authorized dealers for repairs and adjustments. Improper adjustments could lead to accidents and scooter malfunction.
- Regularly check all wiring connections. Regularly check all wiring insulation, including the charger power cord, for wear or damage. Have your authorized dealer repair or replace any damaged connector, connection, or insulation that you find before using your powerchair again.
- You should keep electrical connections away from sources of dampness, including direct exposure to water or bodily fluids and incontinence. Check electrical components frequently for signs of corrosion and replace as necessary.

12.8 STORAGE

- The best place to store your powerchair – either overnight or for longer periods – is in a dry, clean and secure space, ideally with a mains electricity socket so you can charge it at the same time. A lockable garage or a secure shed is ideal.
- When storing for long periods of time your powerchair should still be charged regularly. See 11.0 Batteries and Charging for more information.

RECYCLING & DISPOSAL

To make sure your powerchair is in good condition, go to your powerchair dealer regularly.

- The equipment wrapping is potentially recyclable.
- The metal parts are used for scrap metal recycling. The plastic parts are used for plastic recycling.
- Electric components and printed circuit boards are disposed of as electronic scrap.
- Exhausted or damaged batteries can be returned to your medical equipment supplier.
- Disposal must be carried out in accordance with the respective national legal provisions.
- Ask your city or district council for details of the local waste management companies.

SERVICE LIFE

We estimate a service life of five years for this product, provided it is used in strict accordance with the intended use as set out in this document and all maintenance and service requirements are met. The estimated service can be exceeded if the product is carefully used and properly maintained, and provided technical and scientific advances do not result in technical limitations. The service life can also be considerably reduced by extreme or incorrect usage. The fact that we estimate a service life for this product does not constitute an additional warranty.

14.0 Basic Troubleshooting

This table is only a guide to aid you in getting your powerchair operating, should you have any problems. If you are unable to get your powerchair operating, please contact your powerchair Dealer.

Symptom	Possible	Solution
Powerchair does not move	<ol style="list-style-type: none">1. Joystick or battery box switch is not "ON"2. Main circuit breaker tripped3. Brake release levers in 'Free-wheel Mode'4. Charger connected to outlet5. Battery power low6. Powerchair shuts down to conserve battery7. Controller error	<ol style="list-style-type: none">1. Turn Joystick switch and battery box switch to "ON"2. Reset circuit breaker3. Place levers in 'Drive Mode'4. Disconnect charger5. Recharge battery6. Turn Joystick switch "OFF", then "ON"7. Check Power light for Flash Code (See 16.0 Flash Codes to get a solution)
Range less than expected	<ol style="list-style-type: none">1. Charging too infrequently2. Defective or worn out battery3. Cold weather reduces battery life4. Defective charger	<ol style="list-style-type: none">1. Charge powerchair more often2. Load test batteries. If necessary replace.3. Allow batteries to reach room temperature and then fully re-charge4. Contact your powerchair Dealer

Powerchair controller internal diagnostics

The diagnostic flash codes for your powerchair are designed to help you perform basic troubleshooting quickly and easily. A diagnostic flash code flashes from the Power light in the event one of the conditions listed below develops.

Flash Code	Fault	Effect On Powerchair	Solution
1	Battery charge is too low or there is a bad connection.	Powerchair continues to drive	<ul style="list-style-type: none"> • Charge batteries. • Check all battery wiring connections. • Contact your service agent.
2	Bad connection to left hand motor.	Powerchair stops driving	<ul style="list-style-type: none"> • Check all connections between the motor and controller. • Motor may be faulty and need replacing. • Contact your service agent.
3	Faulty left hand motor wiring or a stall condition has been detected.	Powerchair stops driving	<ul style="list-style-type: none"> • Check all connections between the motor and controller. • Motor may be faulty and need replacing. • Contact your service agent.
4	Bad connection to right hand motor.	Powerchair stops driving	<ul style="list-style-type: none"> • Check all connections between the motor and controller. • Motor may be faulty and need replacing. • Contact your service agent.
5	Faulty right hand motor wiring or a stall condition has been detected.	Powerchair stops driving	<ul style="list-style-type: none"> • Check all connections between the motor and controller. • Motor may be faulty and need replacing. • Contact your service agent.
7	A Joystick fault is indicated.	Powerchair stops driving	<ul style="list-style-type: none"> • Make sure the Joystick is in the centre position before switching on the controller. • Contact your service agent.
7 + S	A communication fault is indicated.	Powerchair stops driving	<ul style="list-style-type: none"> • Make sure the Joystick cable is securely connected and not damaged. • Contact your service agent.
8	Controller error.	Powerchair stops driving	<ul style="list-style-type: none"> • Check all wiring connections including main battery connections. • The controller needs replacing. • Contact your service agent.
9	Brake error.	Powerchair stops driving	<ul style="list-style-type: none"> • The electronic brakes have a bad connection or fault. • Check the brakes and motor connections. • Also check the controller connections. • Contact your service agent.
10	Excessive Voltage.	Powerchair stops driving	<ul style="list-style-type: none"> • This is usually caused by poor battery connections. • Check the battery connections.

16.0 WARRANTY

WARRANTY POLICY:

LIMITED WARRANTY. IMPORTANT NOTICE:

To ensure your product warranty is validated you must complete the online application form within 14 days of purchase at the following web-site link:

To complete your warranty please visit:
www.komfi-rider.co.uk/warranty-registration/

16.1 TWO-YEAR LIMITED WARRANTY

Two years on all structural frame components; fork, seat post, and frame.
Structural Frame Components, including

1. Main Frame
2. Fork
3. Seat Post
4. Tiller Frame

16.2 ONE-YEAR LIMITED WARRANTY:

For one (1) year from the date of delivery, we will replace at our discretion to the original purchaser, free of charge, any part or electronic component found upon examination by an authorized representative of One Rehab to be faulty.

1. Electronic controllers
2. Transaxle
3. Motor & Brake: (electronic function ONLY).
4. Charger
5. Any other electrical subassembly

NOTE: If there is an increase in the noise level from the transaxle, the warranty does not apply. An increase in operational noise level usually occurs due to excessive strain on the scooter.

16.3 BATTERIES

Batteries are covered by a six (6) month warranty from the original manufacture and a further six (6) month warranty at the discretion of Komfi-Rider.

Note: Gradual deterioration in performance due to batteries being left in a discharged state, left in cold conditions for long periods of time or worn out through heavy use is not covered.

16.4 Warranty Exclusions

1. ABS plastic shrouds and footrest covers (wear items are not warranted).
 3. Tyres and Anti-tip Wheels (wear items are not warranted).
 4. Upholstery and seating (wear items are not warranted).
 5. Motor Brushes.
 6. Brake Pads (wear items are not warranted).
 7. Fuses.
 8. Repairs and/or modifications made to any part of the scooter without specific and prior consent from **Komfi-Rider**.
 9. Circumstances beyond the control of **Komfi-Rider**.
- Exclusions also include components with damage caused by:

1. Contamination (rain, etc).
2. Abuse, misuse, accident, or negligence.
3. Commercial use, or use other than normal.
4. Improper operation, maintenance, or storage.

NOTE: Gradual deterioration in performance because the battery has been left in a discharged state, left in cold conditions for an extended period of time, or worn out through heavy use is not covered by the warranty.

16.5 SERVICE CHECKS AND WARRANTY SERVICE

This warranty is extended only to the original purchaser. Your original receipt will be necessary as proof of purchase before any warranty performances are rendered.

This warranty only covers failures due to defects in materials or workmanship which occur during normal use and does not cover damage that occurs in shipment or failures which are caused by products not supplied by **Komfi-Rider** or failures resulting from accident, misuse, abuse, neglect, mishandling, misapplication, alteration, modification, commercial use or by anyone

other than an authorized dealer, or damage that is attributable to the acts of God.

The manufacturer reserves the right to alter without notice, any weights, measurements or other technical data shown in this manual. All figures, measurements and capacities shown in this manual are approximate and do not constitute specifications.

16.6 NOTICES TO CONSUMER

There are no other express warranties. To the extent permitted by law, any implied warranty (including a warranty of merchantability or fitness for a particular purpose) is limited to:

1. One (1) year from the day of original delivery
2. Repair or replacement of the defective part only.

Warranty Application Form

Important Notice – To ensure your product warranty is validated you must complete the online application form within 14 days of purchase.

To complete your warranty please visit:

www.komfi-rider.co.uk/warranty-registration/

INTENTIONALLY LEFT BLANK

INTENTIONALLY LEFT BLANK

OLYMPUS CF



Manufacture: Komfi-Rider, Fernwood Estate, Shillinglee Road, Surrey, GU8 4SX

Authorized Dealer:

